



Racks, Cabinets, & Infrastructure



Wire Basket Tray

© 2020 Vericom Global Solutions

info@vericomsolutions.com • vericomsolutions.com

Introduction

Vericom's Wire Basket Tray System is a highly configurable and adaptable cable runway solution designed to meet the needs of a variety of applications, from short cable runs in a data closet to high-density data center installations. Featuring a rigid construction and a corrosion-resistant powder coated finish, our trays offer

the strength and durability to protect valuable network communications cabling, simplify system extensions, and reduce the cost of maintenance. And with an extensive portfolio of available tray sizes, splicing accessories, and support structures, the Vericom Wire Basket Tray System is a great choice for your next telecommunications, data center, enterprise, or institutional project.

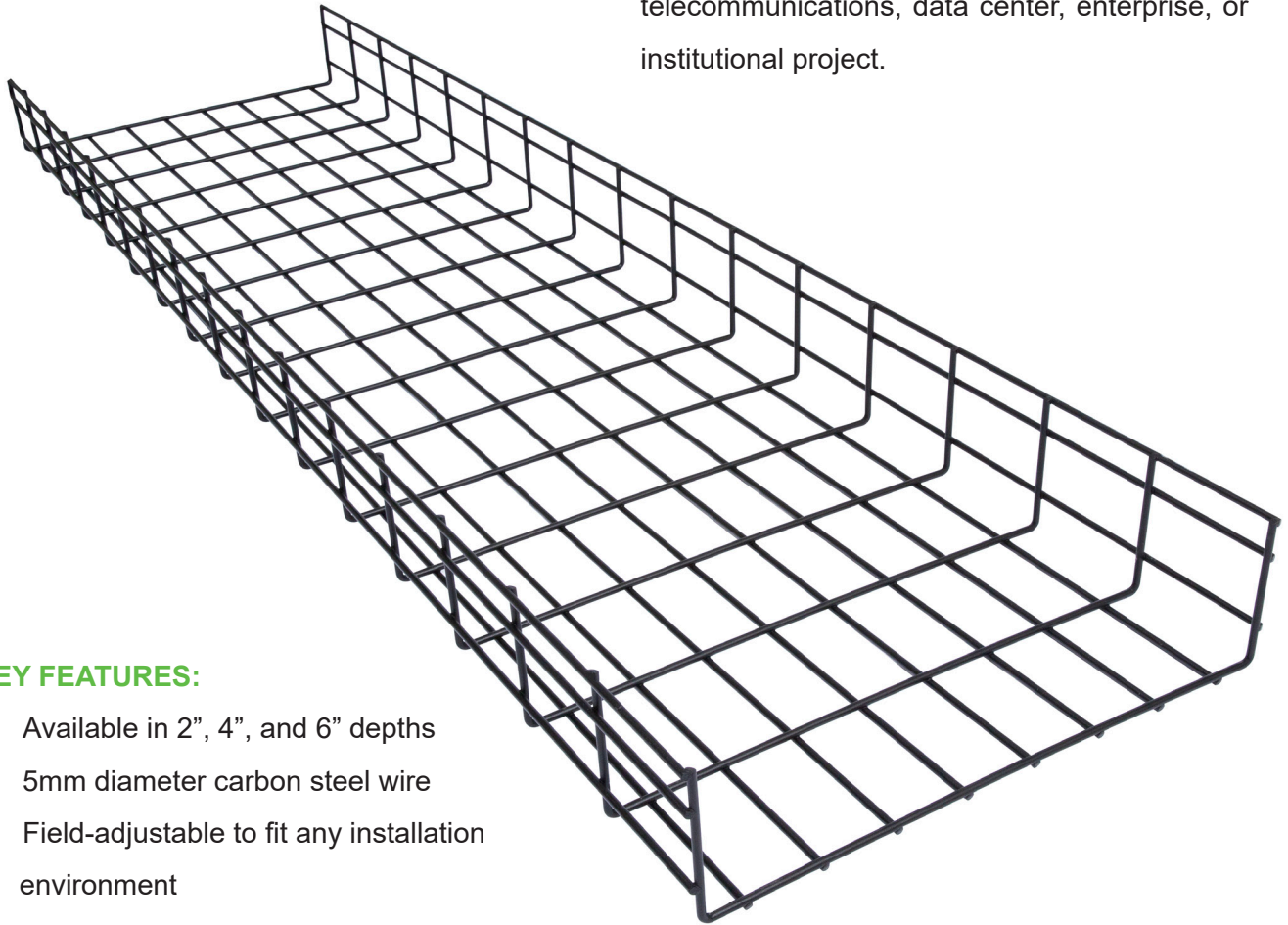

KEY FEATURES:

- Available in 2", 4", and 6" depths
- 5mm diameter carbon steel wire
- Field-adjustable to fit any installation environment
- Conforms to IEC 61537 international standards for cable tray systems

Wire Basket Tray

Basket Tray

VERICOM

The Future Of Technology - Today.

2 Inch Deep Basket Tray

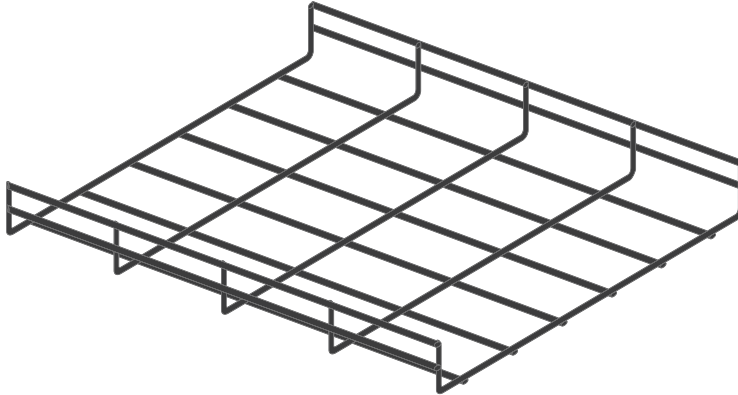

- Height: 2.36" (60mm)
- Length: 118.11" (3m)
- Available Widths: 2, 4, 6, 8, 12, 16, 18, 20, & 24"
(50, 100, 150, 200, 300, 400, 450, 500, & 600mm)
- Wire Dia.: 0.197" (5mm)
- Finish: Black Powder Coat
- IEC 61537 compliant

ITEM NUMBER	WIDTH		WT PER PC		LOAD (lbs/ft)*		CABLE FILL **		SPLICE QTY	AVAILABILITY	SECTION VIEW
	in	mm	lbs	kgs	5 ft span	6.5 ft span	CAT6***	CAT6A***			
VBT-ST05050-BP	2	50	20.11	9.12	n/a	n/a	49	35	2	Special order	
VBT-ST05100-BP	4	100	24.74	11.22	18.14	14.78	98	71	3	Special order	
VBT-ST05150-BP	6	150	29.43	13.35	36.29	28.22	148	106	3	Special order	
VBT-ST05200-BP	8	200	34.13	15.48	55.1	38.3	197	142	3	Special order	
VBT-ST05300-BP	12	300	43.32	19.65	55.1	40.99	295	212	4	Stocked	
VBT-ST05400-BP	16	400	52.58	23.85	66.52	45.02	393	283	4	Stocked	
VBT-ST05450-BP	18	450	57.2	25.95	66.52	47.38	442	318	4	Stocked	
VBT-ST05500-BP	20	500	61.84	28.05	66.52	49.73	492	354	4	Special order	
VBT-ST05600-BP	24	600	71.1	32.25	68.54	47.04	590	425	4	Special order	

*Load calculations based on IEC 61537-2007 standards for cable tray systems testing.

**Cable Fill capacity based on NEC allowable fill of 50%.

***CAT6 rate based on 0.224" diameter; CAT6A rate based on 0.264" diameter. Actual diameters vary by cable manufacturer.

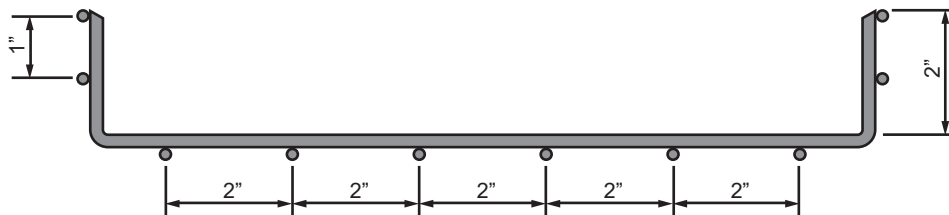

Wire Basket Tray

Basket Tray







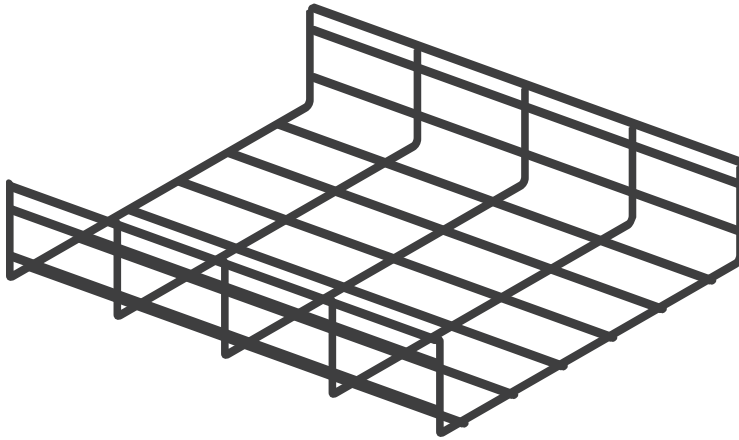

VERICOM®

The Future Of Technology - Today.

4 Inch Deep Basket Tray



- Height: 4.33" (110mm)
- Length: 118.11" (3m)
- Available Widths: 4, 6, 8, 12, 16, 18, 20, & 24"
(100, 150, 200, 300, 400, 450, 500, & 600mm)
- Wire Dia.: 0.197" (5mm)
- Finish: Black Powder Coat
- IEC 61537 compliant

ITEM NUMBER	WIDTH		WT PER PC		LOAD (lbs/ft)*		CABLE FILL**		SPLICE QTY	AVAILABILITY	SECTION VIEW
	in	mm	lbs	kgs	5 ft span	6.5 ft span	CAT6***	CAT6A***			
VB-T-ST10100-BP	4	100	34.06	15.45	22.85	18.82	197	142	3	Special order	
VB-T-ST10150-BP	6	150	38.69	17.55	45.69	34.94	295	212	3	Special order	
VB-T-ST10200-BP	8	200	43.32	19.65	68.54	47.71	393	283	3	Special order	
VB-T-ST10300-BP	12	300	52.58	23.85	68.54	51.07	590	425	4	Stocked	
VB-T-ST10400-BP	16	400	61.84	28.05	83.32	56.45	787	566	4	Stocked	
VB-T-ST104050-BP	18	450	66.47	30.15	83.32	59.14	885	637	4	Stocked	
VB-T-ST10500-BP	20	500	71.1	32.25	83.32	61.82	983	708	4	Special order	
VB-T-ST10600-BP	24	600	80.36	36.45	86.01	53.76	1180	849	4	Special order	

*Load calculations based on IEC 61537-2007 standards for cable tray systems testing.

**Cable Fill capacity based on NEC allowable fill of 50%.

***CAT6 rate based on 0.224" diameter; CAT6A rate based on 0.264" diameter. Actual diameters vary by cable manufacturer.

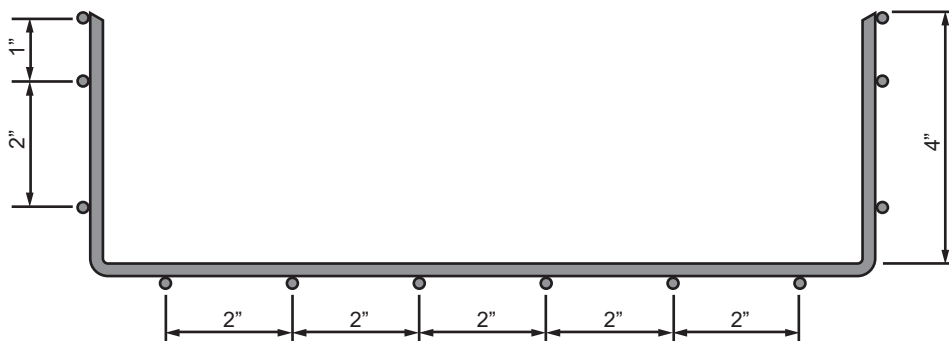

Wire Basket Tray

Basket Tray

VERICOM®

The Future Of Technology - Today.

6 Inch Deep Basket Tray

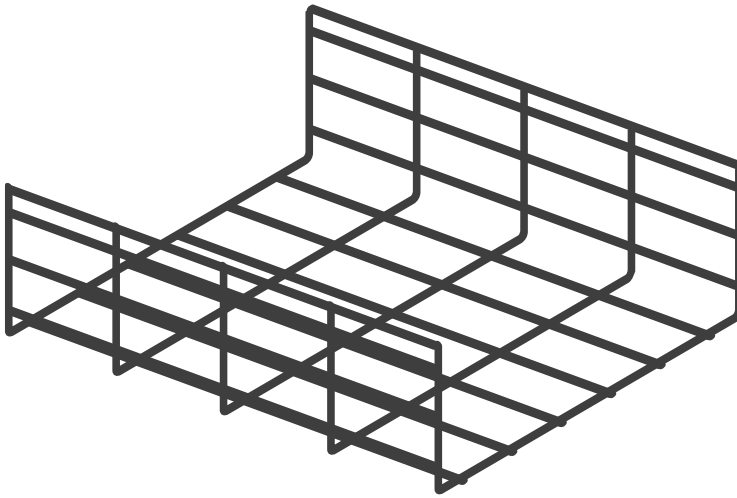

- Height: 6.3" (160mm)
- Length: 118.11" (3m)
- Available Widths: 12, 16, 20, & 24" (300, 400, 500, & 600mm)
- Wire Dia.: 0.197" (5mm)
- Finish: Black Powder Coat
- IEC 61537 compliant

ITEM NUMBER	WIDTH		WT PER PC		LOAD (lbs/ft)*		CABLE FILL**		SPLICE QTY	AVAILABILITY	SECTION VIEW
	in	mm	lbs	kgs	5 ft span	6.5 ft span	CAT6***	CAT6A***			
VBT-ST15300-BP	12	300	61.84	28.05	78.82	58.73	885	637	4	Special order	
VBT-ST15400-BP	16	400	71.1	32.25	95.82	64.92	1180	849	4	Special order	
VBT-ST15500-BP	20	500	79.92	36.45	95.82	71.09	1475	1062	4	Special order	
VBT-ST15600-BP	24	600	89.62	40.65	98.91	61.82	1770	1274	4	Special order	

*Load calculations based on IEC 61537-2007 standards for cable tray systems testing.

**Cable Fill capacity based on NEC allowable fill of 50%.

***CAT6 rate based on 0.224" diameter; CAT6A rate based on 0.264" diameter. Actual diameters vary by cable manufacturer.

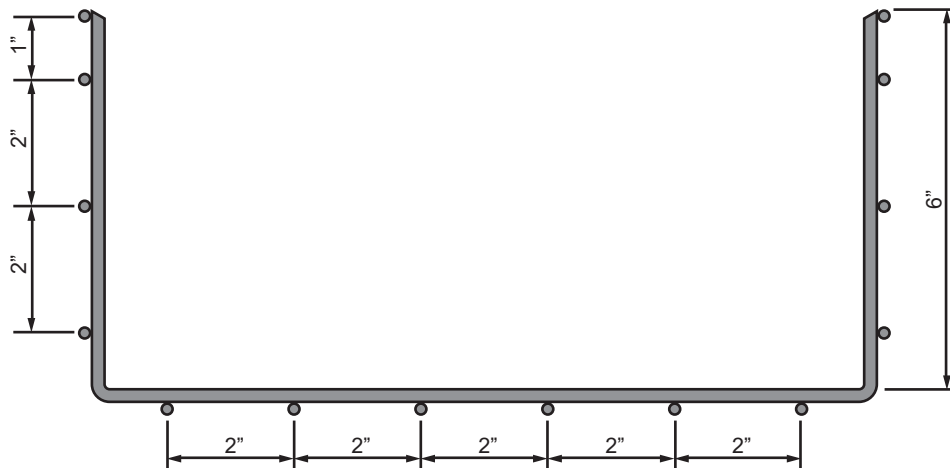

Wire Basket Tray

Splicing



The Future Of Technology - Today.

Washer Splice Kit



Washer Splice Kits are used to connect two pieces of basket tray. Each 4-piece kit includes a top splice washer, bottom splice washer, M6x20 carriage bolt, and a M6 flange nut.

- Compatible with all tray sizes
- Black powder coat finish
- 50 sets per bag

ITEM NUMBER	DESCRIPTION	DIMENSIONS (L x W x H)	WEIGHT	AVAILABILITY
VBT-SW-BP-B50	Washer Splice Kit	n/a	4.5 lbs (per 50)	Stocked

Snap-in Splice Clip

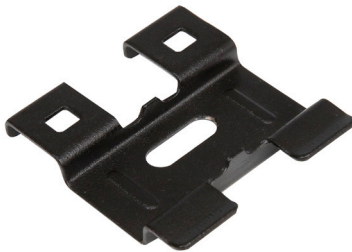

This toolless splice clip offers fast and easy installation when connecting two sections of basket tray.

- Compatible with all tray sizes
- Toolless installation
- Black powder coat finish
- 50 sets per bag

ITEM NUMBER	DESCRIPTION	DIMENSIONS (L x W x H)	WEIGHT	AVAILABILITY
VBT-SA-BP-B50	Snap-in Splice Clip	2.48" x 2.17" x 0.41"	3.6 lbs (per 50)	Stocked

Splicing Chart (number of splices required per joint)

Tray Height	Tray Width - number of splices							
	2 in (50 mm)	4 in (100 mm)	6 in (150 mm)	8 in (200 mm)	12 in (300 mm)	16 in (400 mm)	20 in (500 mm)	24 in (600 mm)
2 in	2	3	3	3	4	4	4	4
4 in	n/a	3	3	3	4	4	4	4
6 in	n/a	n/a	n/a	n/a	4	4	4	4

Quick Splice Bar



Quick Splice Bars are a convenient option for connecting two straight pieces of the same width basket tray. No screws, nuts, or other hardware required.

- Compatible with all tray sizes
- Fast and easy installation (no additional hardware required)
- Great for high load capacity installations
- Black powder coat finish
- 50 pcs per bag

ITEM NUMBER	DESCRIPTION	DIMENSIONS (L x W x H)	WEIGHT	AVAILABILITY
VBT-SQ-BP-B50	Quick Splice Bar	10.7" x 1" x 0.6"	11.25 lbs (per 50)	Stocked

Bar Splice Kit



The Bar Splice Kit provides additional strength when joining two basket trays on a horizontal plane. Each kit includes one straight bar splice and 3 sets of M6x20 carriage bolts, M6 nuts, and top splice washers.

- For use on sides of tray only
- Compatible with all tray sizes
- Black powder coat finish
- 10 sets per bag

ITEM NUMBER	DESCRIPTION	DIMENSIONS (L x W x H)	WEIGHT	AVAILABILITY
VBT-SB-BP-B10	Bar Splice Kit	2.48" x 0.71" x 0.89"	4.07 lbs (per 10)	Stocked

Splicing Chart (number of splices required per joint)

Tray Height	Tray Width - number of splices							
	2 in (50 mm)	4 in (100 mm)	6 in (150 mm)	8 in (200 mm)	12 in (300 mm)	16 in (400 mm)	20 in (500 mm)	24 in (600 mm)
2 in	2	3	3	3	4	4	4	4
4 in	n/a	3	3	3	4	4	4	4
6 in	n/a	n/a	n/a	n/a	4	4	4	4

Corner Splice Kit



This kit provides support at horizontal 90 degree turns and tee junctions. Each kit includes one right-angle bar splice and two sets of M6x20 carriage bolts, M6 nuts, and top splice washers.

- Compatible with all tray sizes
- Black powder coat finish
- Sold individually

ITEM NUMBER	DESCRIPTION	DIMENSIONS (L x W x H)	WEIGHT	AVAILABILITY
VBT- SC-BP	Corner Splice Kit	5" x 5" x 0.75"	0.4 lbs	Stocked

Radius Splice



Radius Splices are a fast and easy solution for maintaining minimum cable bend radius at 90 degree bends, tees, and cross intersections. Each kit includes one radius bar and four sets of M6x20 carriage bolts, M6 nuts, and top splice washers.

- Reduces field fabrication time
- Provides a 5.5" radius at tee and cross intersections
- Compatible with all tray widths
- Available for 2", 4", and 6" tray depths
- Black powder coat finish
- Sold individually

ITEM NUMBER	DESCRIPTION	DIMENSIONS (L x W x H)	WEIGHT	AVAILABILITY
VBT-SR05140-BP	Radius Splice for 2" Deep Tray	11.42" x 11.42" x 1.97"	0.53 lbs	Stocked
VBT-SR10140-BP	Radius Splice for 4" Deep Tray	11.42" x 11.42" x 3.94"	0.6 lbs	Stocked
VBT-SR15140-BP	Radius Splice for 6" Deep Tray	11.42" x 11.42" x 5.91"	0.67 lbs	Special Order

Wire Basket Tray

Splicing

Center Clip



Center clips can be used to connect two sections of basket tray at any angle, to secure two halves of one section formed into a horizontal bend, or to create a center hanging support for ceiling mounting.

- Compatible with all tray sizes
- Black powder coat finish
- 50 pcs per bag

ITEM NUMBER	DESCRIPTION	DIMENSIONS (L x W x H)	WEIGHT	AVAILABILITY
VBT-CC-BP-B50	Center Clip	2.32" x 1.57" x 0.14"	5.4 lbs (per 50)	Stocked

L Bracket



L Brackets provide a secure method for mounting basket tray to a wall.

- Helps maintain a consistent distance between the basket tray and a wall
- For use with 4" (100mm) to 16" (400mm) wide tray
- Compatible with all tray depths
- Black powder coat finish
- Hardware for mounting to wall not included
- Sold individually

ITEM NUMBER	DESCRIPTION	DIMENSIONS (L x W x H)	WEIGHT	AVAILABILITY
VBT-WL100-BP	L Bracket for 4"W Tray	7" x 2" x 7.1"	0.8 lbs	Special order
VBT-WL150-BP	L Bracket for 6"W Tray	9" x 2" x 7.1"	0.9 lbs	Special order
VBT-WL200-BP	L Bracket for 8"W Tray	11" x 2" x 7.1"	1 lbs	Special order
VBT-WL300-BP	L Bracket for 12"W Tray	15" x 2" x 7.1"	1.3 lbs	Stocked
VBT-WL400-BP	L Bracket for 16"W Tray	19" x 2" x 7.1"	1.4 lbs	Stocked

M-type L Bracket



The M-type L Bracket provides additional strength when mounting high capacity basket tray to a wall.

- Helps maintain a consistent distance between the basket tray and a wall
- For use with 4" (100mm) to 16" (400mm) wide tray
- Compatible with all tray depths
- Black powder coat finish
- Hardware for mounting to wall not included
- Sold individually

ITEM NUMBER	DESCRIPTION	DIMENSIONS (L x W x H)	WEIGHT	AVAILABILITY
VBT-WM100-BP	M-type L Bracket for 4"W Tray	7" x 2.5" x 7.5"	0.7 lbs	Special order
VBT-WM150-BP	M-type L Bracket for 6"W Tray	9" x 2.5" x 7.5"	0.8 lbs	Special order
VBT-WM200-BP	M-type L Bracket for 8"W Tray	11" x 2.5" x 7.5"	0.9 lbs	Special order
VBT-WM300-BP	M-type L Bracket for 12"W Tray	15" x 2.5" x 7.5"	1.1 lbs	Special order
VBT-WM400-BP	M-type L Bracket for 16"W Tray	19" x 2.5" x 7.5"	1.3 lbs	Special order

Shelf Wall Bracket



Shelf Wall Brackets are a heavy-duty option for mounting high capacity basket tray to a wall.

- Heavy duty construction for high density installations
- Helps maintain a consistent distance between the basket tray and a wall
- For use with 4" (100mm) to 18" (450mm) wide tray
- Compatible with all tray depths
- Black powder coat finish
- Hardware for mounting to wall not included
- Sold individually

ITEM NUMBER	DESCRIPTION	DIMENSIONS (L x W x H)	WEIGHT	AVAILABILITY
VBT-WS100-BP	Shelf Wall Bracket for 4"W Tray	7.9" x 2" x 4.5"	0.95 lbs	Special order
VBT-WS150-BP	Shelf Wall Bracket for 6"W Tray	9.8" x 2" x 4.5"	1.08 lbs	Special order
VBT-WS200-BP	Shelf Wall Bracket for 8"W Tray	11.8" x 2" x 5"	1.24 lbs	Special order
VBT-WS300-BP	Shelf Wall Bracket for 12"W Tray	15.7" x 2" x 6"	1.48 lbs	Stocked
VBT-WS400-BP	Shelf Wall Bracket for 16"W Tray	19.7" x 2" x 6"	1.69 lbs	Stocked
VBT-WS450-BP	Shelf Wall Bracket for 18"W Tray	21.7" x 2" x 6"	1.90 lbs	Stocked

Wire Basket Tray

Wall Mount Supports

Wall Mount Bracket



This wall mount bracket is an ideal option for mounting 2" and 4" wide basket tray where wall space is limited.

- Multiple screw hole locations
- Mount to a wall, strut or cabinet
- Black powder coat finish
- Hardware for mounting to wall not included
- Sold individually

ITEM NUMBER	DESCRIPTION	DIMENSIONS (L x W x H)	WEIGHT	AVAILABILITY
VBT-WZ-BP	Wall Mount Bracket	3.7" x 0.9" x 3"	0.23 lbs	Stocked

Wall Clip

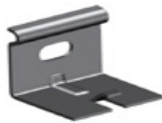

Wall clips allow a 2" or 4" basket tray to be mounted flush against a wall.

- For light load installations
- Mount to a wall, strut, or cabinet
- Black powder coat finish
- Hardware for mounting to wall not included
- Sold individually

ITEM NUMBER	DESCRIPTION	DIMENSIONS (L x W x H)	WEIGHT	AVAILABILITY
VBT-WC-BP	Wall Clip	1.6" x 1.4" x 1.5"	0.19 lbs	Stocked

Wire Basket Tray

Ceiling Mount Supports

Cross Bar



Cross bars can be suspended from the ceiling to provide overhead support for basket tray runs.

- Compatible with threaded rod up to 3/8" diameter (not included)
- Secures basket tray without screws or clamps
- For use with 4" (100mm) to 24" (600mm) wide basket tray
- Black powder coat finish
- Sold individually

ITEM NUMBER	DESCRIPTION	DIMENSIONS (L x W x H)	WEIGHT	AVAILABILITY
VB-T-BU100-BP	Cross Bar for 4"W Tray	7.1" x 2" x 0.8"	0.46 lbs	Special order
VB-T-BU200-BP	Cross Bar for 8"W Tray	11" x 2" x 0.8"	0.77 lbs	Special order
VB-T-BU300-BP	Cross Bar for 12"W Tray	15" x 2" x 0.8"	1.1 lbs	Stocked
VB-T-BU400-BP	Cross Bar for 16"W Tray	18.9" x 2" x 0.8"	1.43 lbs	Stocked
VB-T-BU450-BP	Cross Bar for 18"W Tray	20.8" x 2" x 0.8"	1.6 lbs	Stocked
VB-T-BU500-BP	Cross Bar for 20"W Tray	22.8" x 2" x 0.8"	1.76 lbs	Special order
VB-T-BU600-BP	Cross Bar for 24"W Tray	26.8" x 2" x 0.8"	2.09 lbs	Special order

M-Type Cross Bar



M-type cross bars provide additional strength when suspending high capacity basket tray from the ceiling.

- Compatible with threaded rod up to 3/8" diameter (not included)
- Secures basket tray without screws or clamps
- For use with 4" (100mm) to 24" (600mm) wide basket tray
- Black powder coat finish
- Sold individually

ITEM NUMBER	DESCRIPTION	DIMENSIONS (L x W x H)	WEIGHT	AVAILABILITY
VB-T-BM100-BP	M-Type Cross Bar for 4"W Tray	7.1" x 2.5" x 0.8"	0.42 lbs	Special order
VB-T-BM200-BP	M-Type Cross Bar for 8"W Tray	11" x 2.5" x 0.8"	0.69 lbs	Special order
VB-T-BM300-BP	M-Type Cross Bar for 12"W Tray	15" x 2.5" x 0.8"	0.99 lbs	Stocked
VB-T-BM400-BP	M-Type Cross Bar for 16"W Tray	18.9" x 2.5" x 0.8"	1.29 lbs	Stocked
VB-T-BM450-BP	M-Type Cross Bar for 18"W Tray	20.8" x 2.5" x 0.8"	1.44 lbs	Stocked
VB-T-BM500-BP	M-Type Cross Bar for 20"W Tray	22.8" x 2.5" x 0.8"	1.59 lbs	Special order
VB-T-BM600-BP	M-Type Cross Bar for 24"W Tray	26.8" x 2.5" x 0.8"	1.89 lbs	Special order

Hanging Bracket



This bracket is used to suspend 2" wide basket tray from the ceiling and offers tool-free and hardware-free connection to the tray.

- For use with 2" (50mm) wide basket tray only
- Compatible with threaded rod up to 3/8" in diameter (not included)
- Secures basket tray without screws or clamps
- Black powder coat finish
- Sold individually

ITEM NUMBER	DESCRIPTION	DIMENSIONS (L x W x H)	WEIGHT	AVAILABILITY
VBT-HB-BP	Hanging Bracket	2.9" x 1.2" x 1.2"	0.29 lbs	Special order

Hanging Clip



Hanging clips are a cost-effective way to suspend basket tray from the ceiling. Two clips are required per support location.

- For use with any basket tray up to 12" (300mm) wide
- Compatible with threaded rod up to 3/8" in diameter (not included)
- Secures basket tray without screws or clamps
- Black powder coat finish
- Sold individually

ITEM NUMBER	DESCRIPTION	DIMENSIONS (L x W x H)	WEIGHT	AVAILABILITY
VBT-HC-BP	Hanging Clip	1.5" x 1.4" x 1.7"	0.21 lbs	Stocked

Wire Basket Tray

Floor/Cabinet Mount Supports

VERICOM

The Future Of Technology - Today.

Stand-Off Kit



Stand-off kits provide a stable option for mounting basket tray to a floor or on top of a cabinet. Each kit includes two vertical posts, a cross bar, and all required assembly hardware.

- Elevates basket tray above the mounting surface
- Hardware for mounting to floor/cabinet not included
- Black powder coat finish
- Sold individually

ITEM NUMBER	DESCRIPTION	DIMENSIONS (L x W x H)	WEIGHT	AVAILABILITY
VBT-SO05100-BP	2" Stand-Off Kit for 4"W Tray	7.1" x 5.0" x 2.8"	0.75 lbs	Special Order
VBT-SO10100-BP	4" Stand-Off Kit for 4"W Tray	7.1" x 5.0" x 4.7"	0.75 lbs	Stocked
VBT-SO10200-BP	4" Stand-Off Kit for 8"W Tray	11.0" x 5.0" x 4.7"	1.79 lbs	Stocked
VBT-SO20300-BP	8" Stand-Off Kit for 12"W Tray	15.0" x 5.0" x 8.7"	n/a	Special Order
VBT-SO20400-BP	8" Stand-Off Kit for 16"W Tray	18.9" x 5.0" x 8.7"	n/a	Special Order
VBT-SO20450-BP	8" Stand-Off Kit for 18"W Tray	20.9" x 5.0" x 8.7"	n/a	Stocked
VBT-SO20500-BP	8" Stand-Off Kit for 20"W Tray	22.8" x 5.0" x 8.7"	n/a	Special Order
VBT-SO20600-BP	8" Stand-Off Kit for 24"W Tray	26.8" x 5.0" x 8.7"	n/a	Special Order

Wire Basket Tray

Floor/Cabinet Mount Supports

VERICOM®

The Future Of Technology - Today.

Floor Mount Bracket



This bracket can be used to mount 2" wide basket tray to the floor or to the top of a cabinet.

- For use with 2" (50mm) wide basket tray only
- Secures basket tray without screws or clamps
- Hardware for mounting to floor/cabinet not included
- Black powder coat finish
- Sold individually

ITEM NUMBER	DESCRIPTION	DIMENSIONS (L x W x H)	WEIGHT	AVAILABILITY
VBT-FB050-BP	Floor Mount Bracket for 2"W Tray	2.9" x 1.2" x 2.4"	0.17 lbs	Special order

Floor Mount Bracket



This bracket provides 2.5" of clearance above the floor or top of a cabinet

- For use with 4", 6", or 8" (100mm, 150mm, 200mm) wide basket tray
- Secures basket tray without screws or clamps
- Hardware for mounting to floor/cabinet not included
- Black powder coat finish
- Sold individually

ITEM NUMBER	DESCRIPTION	DIMENSIONS (L x W x H)	WEIGHT	AVAILABILITY
VBT-FB100-BP	Floor Mount Bracket for 4"W Tray	3.9" x 3.4" x 3.9"	0.75 lbs	Special order
VBT-FB150-BP	Floor Mount Bracket for 6"W Tray	5.9" x 3.4" x 3.9"	1.15 lbs	Special order
VBT-FB200-BP	Floor Mount Bracket for 8"W Tray	7.9" x 3.4" x 3.9"	1.79 lbs	Special order

Cable Drop



Maintain minimum cable bend radius when dropping cable from a basket tray run down to a cabinet.

- Attaches to any basket tray - no hardware required
- Install at the side, middle, or at the end of a tray
- Tabs on cable drop secure position in tray
- Black powder coat finish
- Sold individually

ITEM NUMBER	DESCRIPTION	DIMENSIONS (L x W x H)	WEIGHT	AVAILABILITY
VBT-CD45-BP	Cable Drop 1.75"W	8.5" x 1.7" x 2.6"	0.23 lbs	Stocked
VBT-CD90-BP	Cable Drop 3.5"W	8.5" x 3.6" x 2.6"	0.46 lbs	Stocked



Vericom Global Solutions

10025 Investment Drive, Suite 120

Knoxville, TN 37932

www.vericomsolutions.com

sales@vericomsolutions.com

Phone: (865) 671-4455

Fax: (865) 671-4497